

TECHNICAL DATA SHEET

PRODUCT

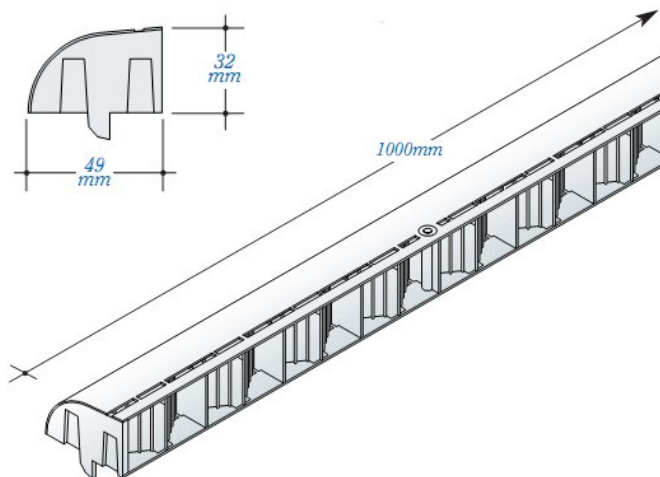

INSTALLATION

1. Used to ventilate pitched roofs, where the roof pitch is 15deg or more and the roof is attic or loft space.

2. Ensure the ventilator is fixed securely into the top of the fascia using screws or nails through the fixings holes provided. Interlock lengths of fascia vent continuously with

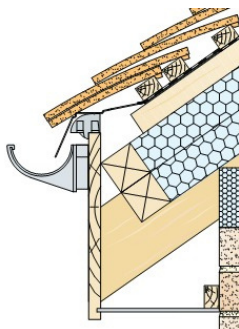

3. On a pitched roof it is advisable to install an eaves skirt above the fascia vent to prevent felt sagging and maintain a clear path into the roof.

4. Ventilation must be provided for the full length of the eaves and along both sides of the building to create continuous airflow.

5. Installed along abutment wall for flat roof. IFV25 fixed to top of continuous board which is connected to vertical battens allowing air to flow between battens.

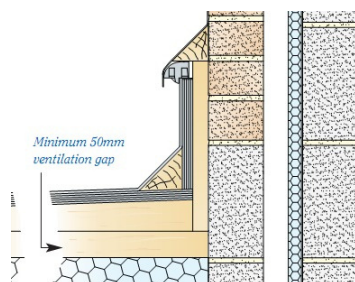

USES

Unobstrusive method of providing ventilation in a range of eaves details.

Used with rafter ventilator to provide continuous ventilation path to roof void.

Can be used to provide ventilation both below or above roof underlay.

IFV25 can also be used for flat roof construction.

FEATURES & BENEFITS

Provides 25,000mm²/m when installed continuously
Internal design provides effective resistance to both driving rain and large insects.

Lightweight and very durable to carry the weight of the bottom row of tiles.

Quick and easy to install

Compatible with all roof tiles and eaves comb fillers

Available in 1m lengths and interlocked with dove-tail ends.

UV stable and resistant to decay.

Complies with roof space ventilation requirements of Building Regulations Approved Document and BS5250.

Gutter bracket spacers available to ensure unrestricted air flow behind the gutter.

Product Details

Free Area	Provides 25,000mm ² /m
Size	1m x 32mm(H) x 49mm (W)
Material	Manufactured injection moulded black polypropylene
Colour	BLACK
Code	IFV25